



Power/mation[®]

Safety Solutions

- Safety Components
- Custom Fencing
- Design & Quote Services
- Ease of Assembly

www.powermation.com
800.843.9859



Safety Components

Power/mation is dedicated to providing a complete range of machine safety products that meet and exceed our customers' safety requirements.

The Power/mation Solutions Group provides the most important piece to the Power/mation safety solutions offering – custom fencing. We are proud to house the fencing workshop in our very own Pewaukee, Wisconsin office location.

Our safety solutions are then completed by having access to a variety of automation safety components from the industry's most trusted suppliers. Let our trained sales staff assess your application and select the right components to complete your safety solution.

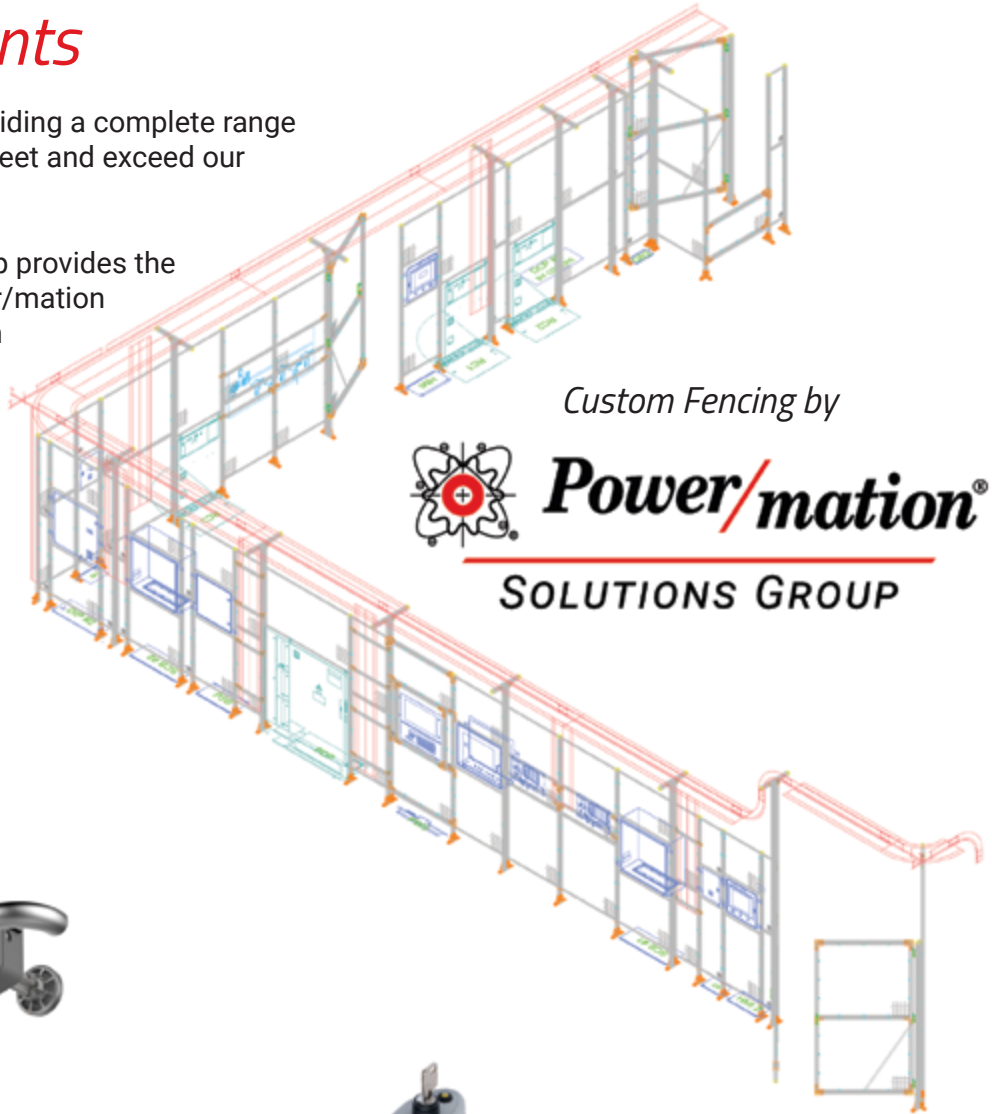

Custom Fencing by



Power/mation[®]

SOLUTIONS GROUP



Light Curtains
& Laser Scanners



Interlock Switches
& Safety Sensors



Enabling
Devices



Safety
Relays



Safety
Controllers



ABB JOKAB SAFETY



Custom Fencing

By partnering with ABB Jokab Safety, custom fencing is now stocked, designed, quoted, processed and distributed by Power/mation. We offer two systems: Express and Standard. Both consist of a minimum number of components including anodized aluminum profile posts with floor brackets, ABB Jokab Safety patented mounting hardware, U-profiles and welded mesh or polycarbonate panels.

The Power/mation Solutions Group will customize a high quality perimeter fencing system that meets your requirements while providing a system that is robust, durable and attractive. There are virtually no limitations to what we can build while still retaining a straightforward process.

Design

Contact your Power/mation sales representative for a safety consultation to determine the best system for your application. We can utilize your existing CAD drawing or you can work with your Power/mation representative to conceptualize your design.

Quote

The Power/mation Solutions Group analyzes your layout and designs your fencing system utilizing ABB Jokab Safety SafeCAD software, aiming to minimize waste and ease customer assembly. The revision process continues until you are completely satisfied with the design.

Build

Aluminum extrusions are precisely cut to your system design requirements. Floor brackets are fastened to the fence posts prior to shipment on our Express Systems, allowing a rapid install. Power/mation has made extensive investments in people and tooling to offer industry-leading turnaround.

Delivery

The fencing hardware, large-format assembly drawings and all other safety components needed to assemble your system are neatly packed in crates to further ease installation. Finally, units are securely shipped with a distinctive, tamper-evident wrap.

Ease of Assembly

To simplify the installation process, the assembly of the system uses everyday tools. The panels and extrusions are pre-cut and labeled, matching the provided assembly drawings. Necessary mounting brackets integrate the patented ABB Jokab Safety T-Lock technology, allowing a hassle-free install while reducing labor and engineering costs.

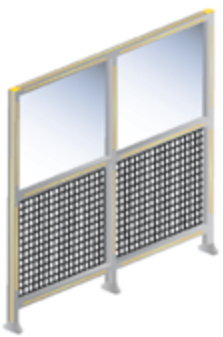

Standard System

- Strongest offering
- Most configurations
- T-Lock mounting system

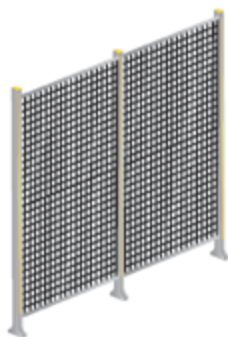

Express System

- Easiest to install
- Lowest cost
- Low-profile netlocks



Standard Tools

- 6mm Hex Key
- 5mm Hex Key
- T25 Torx Bit

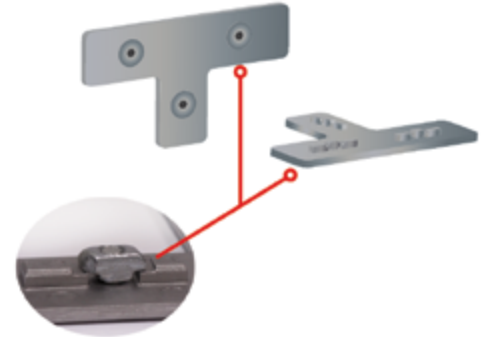

One Step Assembly

- ABB Jokab Safety patented T-Lock mounting system

Corporate Headquarters

St. Paul, MN
1310 Energy Lane
St. Paul, MN 55108
(800) 843-9859
(651) 605-3300
(651) 605-4400 Fax



Office Locations

Pewaukee, WI
N28 W23566 Creative Way
Pewaukee, WI 53072
(800) 242-2060
(262) 408-6100
(262) 523-0611 Fax

Appleton, WI
5485 W Grande Market Dr
Suite A
Appleton, WI 54913
(800) 242-2060
(920) 969-9917

Green Bay, WI
2221 Starr Ct
Green Bay, WI 54303
(800) 924-6260
(920) 497-6354
(920) 496-4363 Fax

Wood Dale, IL
581 N Edgewood Ave
Wood Dale, IL 60191
(800) 847-9896
(630) 475-4240
(630) 860-9177 Fax

Bismarck, ND
1307 Grumman Lane
Bismarck, ND 58504
(833) 200-5086
(651) 605-4400 Fax

Sales Territories

Minnesota

Alexandria
(800) 843-9859 Customer Service
(320) 766-5878 Sales

Duluth
(800) 843-9859 Customer Service
(218) 628-6063 Sales
(218) 628-6063 Fax

Wisconsin

Madison
(800) 242-2060 Customer Service
(262) 523-0611 Fax

Eau Claire
(800) 843-9859 Customer Service
(715) 723-0730 Sales

North Dakota

Fargo
(800) 843-9859 Customer Service
(651) 605-4400 Fax

Minot
(800) 843-9859 Customer Service
(651) 605-4400 Fax

Wahpeton
(800) 843-9859 Customer Service
(651) 605-4400 Fax

South Dakota

Sioux Falls
(800) 843-9859 Customer Service
(605) 335-3046 Sales

Illinois

Rockford
(800) 847-9896 Customer Service
(630) 860-9177 Fax

Iowa

Des Moines
(800) 322-4589 Customer Service
(319) 395-0929 Fax

Cedar Rapids
(800) 322-4589 Customer Service
(319) 395-0929 Fax

Nebraska

Omaha
(800) 428-9036 Customer Service
(402) 445-8728 Fax



Power/mation®

800.843.9859
www.powermation.com

